

**RESOLUTION OF THE
WHITE MOUNTAIN APACHE TRIBE OF THE
FORT APACHE INDIAN RESERVATION**

WHEREAS, the woodlands and rangelands of the White Mountain Apache Tribe have provided firewood, food, shelter, forage, medicine, plants for ceremonies and homes uses, wildlife and watershed protection since time immemorial; and

WHEREAS, in the past, the woodlands and rangelands have been mismanaged by the Trustee United States and currently, the woodland and rangeland ecosystems are not healthy due to the lack of natural fire, overgrazing, and other impacts; and

WHEREAS, the Tribe must take responsibility for managing its woodland and rangeland resources for the long-term health of our ecosystems.

BE IT RESOLVED by the Tribal Council of the White Mountain Apache Tribe that it hereby authorizes the Tribal Forestry Department to request funding from the Bureau of Indian Affairs to establish growth study plots on the Reservation, as attached hereto, that will help guide decisions about woodland and rangeland management.

BE IT FURTHER RESOLVED by the Tribal Council that it hereby supports the effort of Tribal Forestry Department to develop a Woodland and Range Management Plan that will restore healthy watersheds while providing wood products, forage wildlife, medicinal and ceremonial plants, and other benefits to the people.

The foregoing resolution was on August 07, 1996, duly adopted by a vote of ten for and zero against by the Tribal Council of the White Mountain Apache Tribe, pursuant to authority vested in it by the White Mountain Apache Tribal Constitution, including Article IV, Sections 1 (a), (f), (i), (s), (t) and (u) of the Constitution of the Tribe, ratified by the Tribe on September 30, 1993, and approved by the Secretary of the Interior on November 12, 1993, pursuant to Section 16 of the Act of June 18, 1934 (48 Stat. 984).

RECEIVED

AUG 14 1996

**FORT APACHE INDIAN AGENCY
WHITERIVER, ARIZONA**

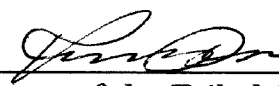
Chairman of the Tribal Council

Secretary of the Tribal Council

PROPOSED PINYON - JUNIPER GROWTH STUDY PLOTS

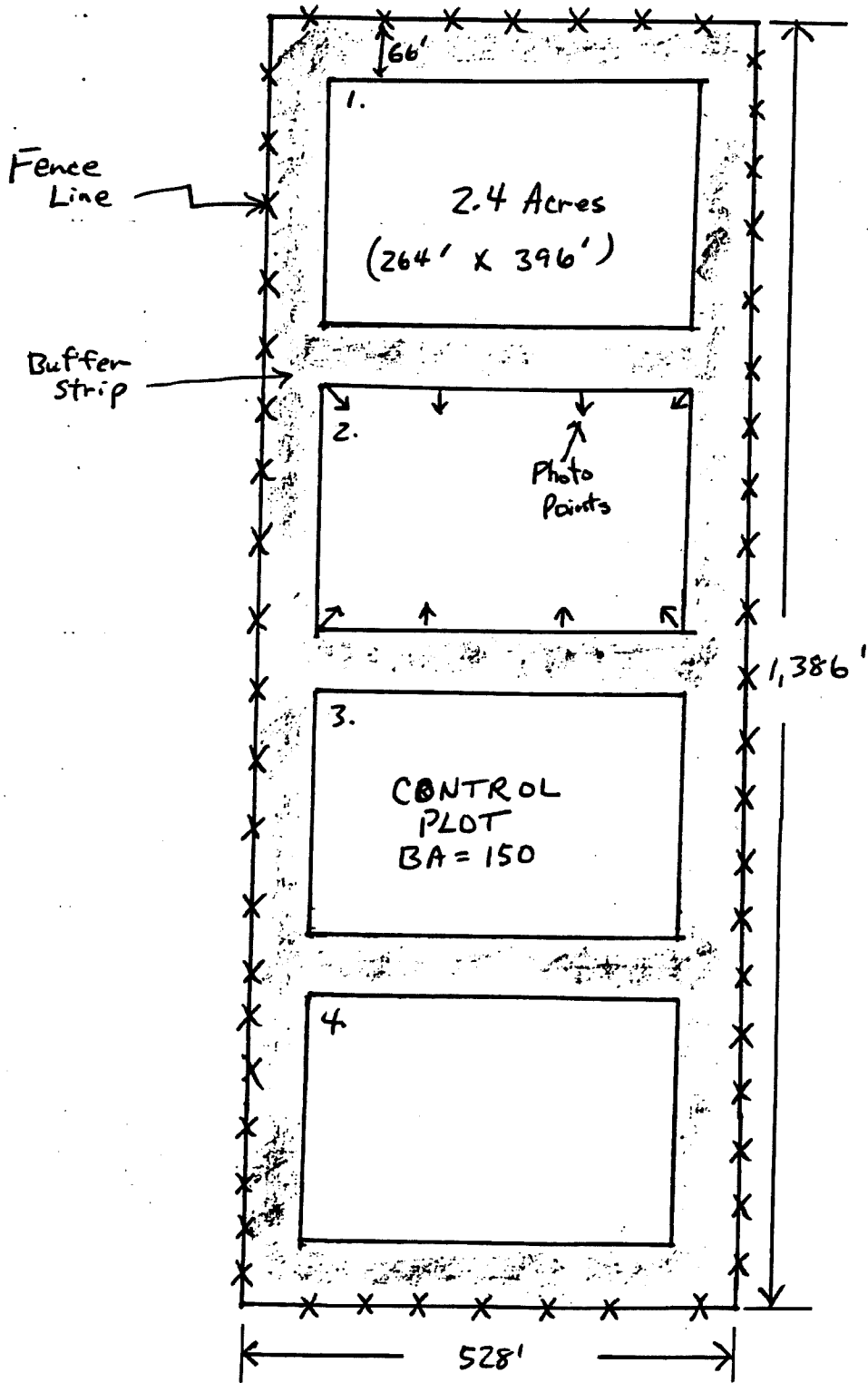

- PLOTS
1. Reduce by 25%
 2. Reduce by 50%
 4. Reduce by 75%

$$528' \times 1,386' = 731,808 \text{ sq.ft.} = 16.8 \text{ Acres}$$

(8 ch.) (21 ch.) $\frac{43,560 \text{ sq.ft./Acre}}$

7/19/96
rd



**PROPOSED
SITE FOR
P-3 STUDY
PLOTS**